







MONTANA

RGB & INDIVIDUAL COLOUR 12W/m · IP67 · 24V · CRI>90

Code	CCT (K)	Lumen output	LED/m
84374	 RGB	180 Lm/M	120 LED/m
84377	 Red	100 Lm/M	140 LED/m
84378	 Blue	75 Lm/M	140 LED/m
84379	 Green	350 Lm/M	140 LED/m
84380	 Yellow	320 Lm/M	140 LED/m
84381	 Pink	190 Lm/M	140 LED/m

Power	Life Time	PCB Thickness
12 W/m	75.000 h	3 oz
Voltage	CRI	SDMC
24V	>90	≤3

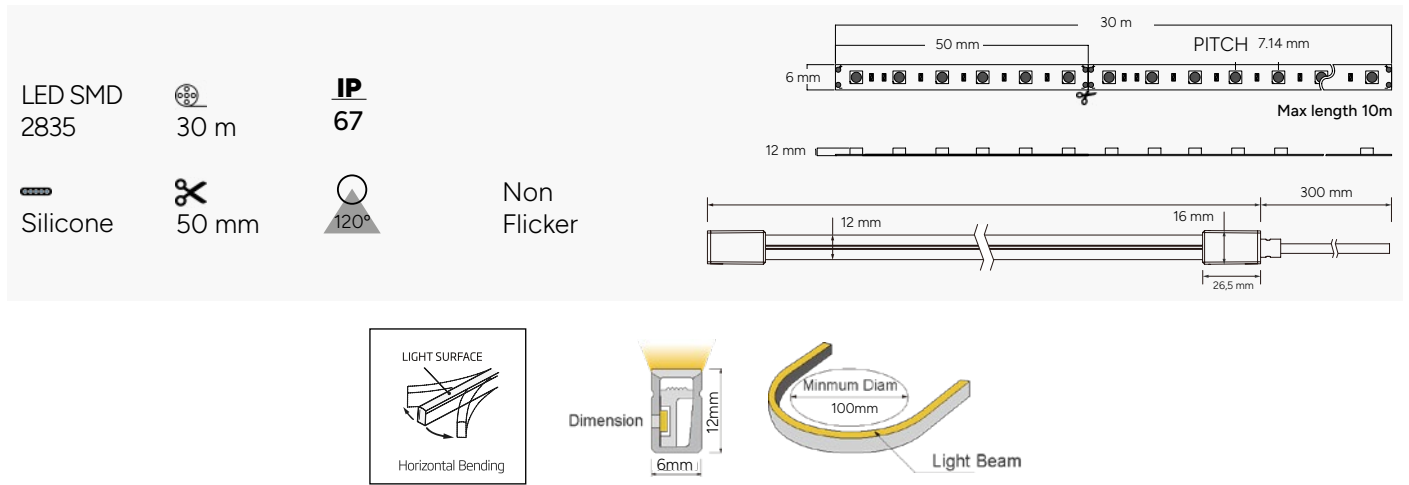

Importante instalar disipador de calor / Important to install heat sink / Important d'installer le dissipateur de chaleur / Importante installare il dissipatore di calore



ACCESORIES

Code	Description
84156	Perfil recto 2 m / Straight profile 2 m / Profilé droit 2 m
84147	Clip de sujeción / Support clip / Clip support
84148	Tapa final / End cap / Embout de fermeture finale
84149	Tapa inicial / Initial cover / Embout de fermeture initiale
84150	Tapa inicial lateral / Side initial cover / Embout de fermeture initiale latérale

